

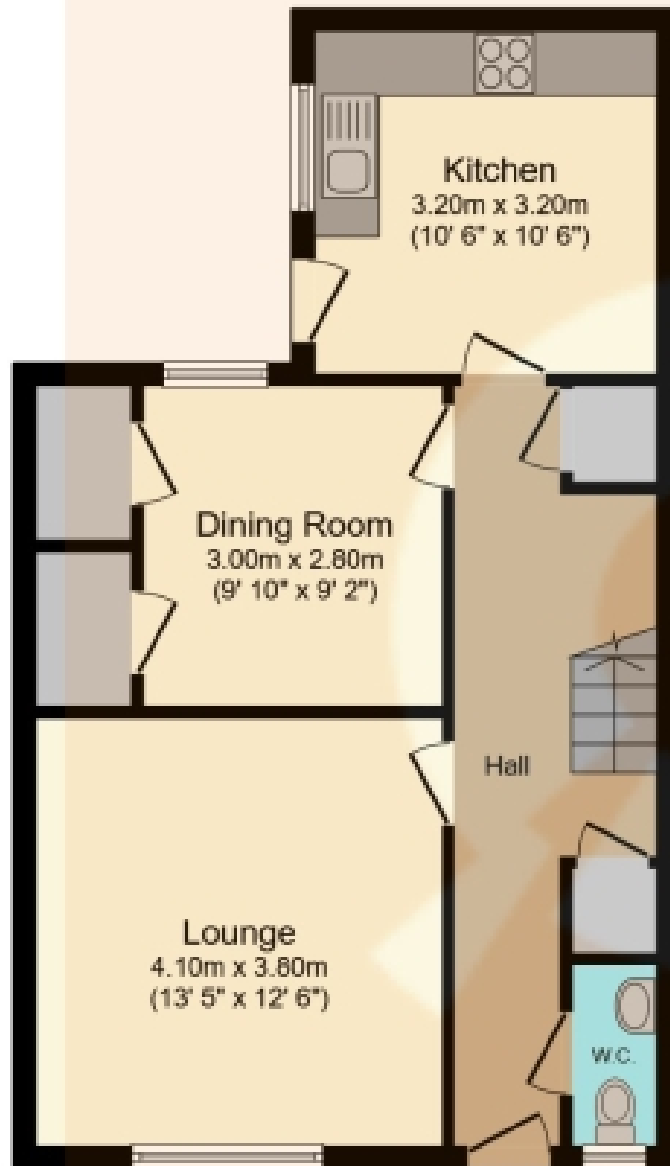

7 Kings Court, Beith

Offers Over £100,000





Ground Floor



First Floor

Total floor area 103.5 sq.m. (1,114 sq.ft.) approx

This plan is for illustration purposes only and may not be representative of the property. Plan not to scale. Powered by PropertyBox

THE PROPERTY

*** 3 BEDROOM 2 PUBLIC ROOM FAMILY HOME *** Rarely available substantial end of terrace property located in the highly desirable town of Beith. This property can easily be a 4 BEDROOM 1 PUBLIC room home if required. Boom highly recommend an early viewing as this property will be popular. Here's what our clients loved about their home... This was my childhood home and I grew up happy here from 7 years old and will be very sad to let it go but I know it's time to let another family enjoy spending time in this fabulous home.

If you require more space, Boom has the property for you. Welcome to No.7 Kings Court, a sizable home which offers flexible accommodation with contemporary fixtures and fittings.

An inviting hallway provides access to the delightful lounge with grey tones and feature wall. A floor to ceiling double glazed window formation ensures the room is awash with natural light.

Indulge your culinary desires in the superbly spacious contemporary kitchen, while the separate dining room sets the stage for unforgettable family gatherings. This flexible accommodation can be configured to 4 bedrooms by utilising the dining room as the 4th bedroom.

Stay organised with ample storage space throughout, including 8 cupboards. A convenient downstairs w.c. completes the ground level. The property further benefits from gas central heating and double glazing which provides a lovely warmth throughout the home.

The upper hall provides access to 3 exceptionally large double bedrooms all with sky lights that engulf the rooms with an abundance of light.

The modern pristine family bathroom features a p-shaped bath and shower, offering both style and functionality.

Outside, the easily maintained gardens and large outdoor shed to the rear offer the perfect space for outdoor activities and storage.

Nestled within the serene Garnock Valley, Beith offers a great lifestyle amidst its rolling hills and verdant countryside. 7 Kings Court is at the heart of all local amenities within the town. The property is within a few minutes' walk of the local shops, health centre and bus stops. Commuting is easy with regular buses providing routes to Glasgow and the coast. Beith weaves a rich tapestry of history and heritage, its streets echoing with stories of times long past, however, what truly sets Beith apart is its warm and welcoming community spirit.

This impressive end of terrace villa will be very popular. We would highly recommend an early viewing of this contemporary accommodation. Viewing by appointment – please contact The Property Boom to arrange a viewing or for any further information and a copy of the Home Report. Any areas, measurements or distances quoted are approximate and floor Plans are only for illustration purposes and are not to scale. Thank you.

THESE PARTICULARS ARE ISSUED IN GOOD FAITH BUT DO NOT CONSTITUTE REPRESENTATIONS OF FACT OR FORM PART OF ANY OFFER OR CONTRACT.

www.thepropertyboom.com
70 West Regent Street, Glasgow, G2 2QZ
Tel: 0333 900 9089 / Email: smile@thepropertyboom.com